

Pls take down the parts from the board by knife, and assemble them as per the procedures as below, we suggest you to stick with 502 glue.

Tools Needed

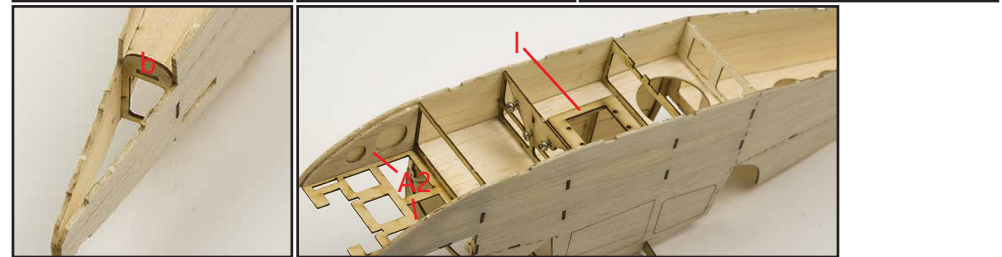

1. Cowling Installation

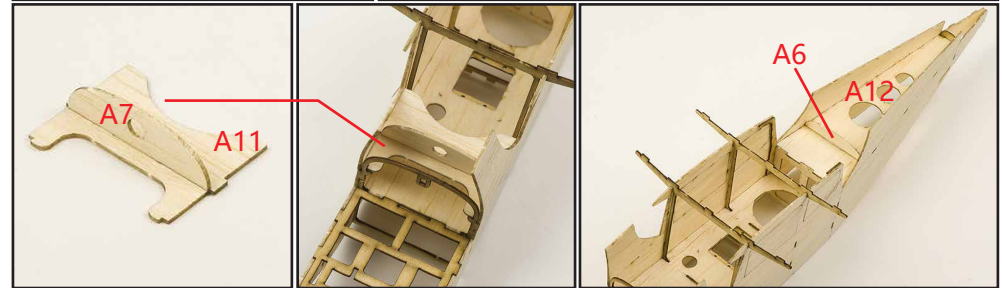
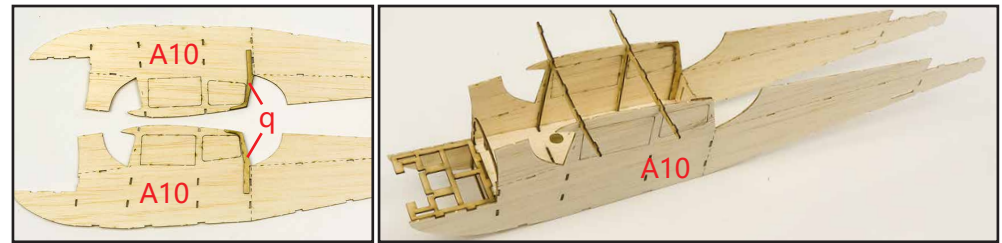
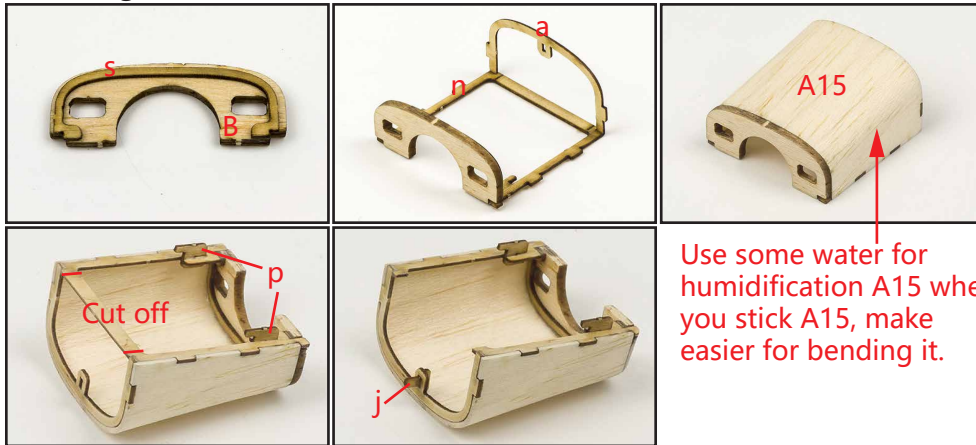

2. Fuselage Installation

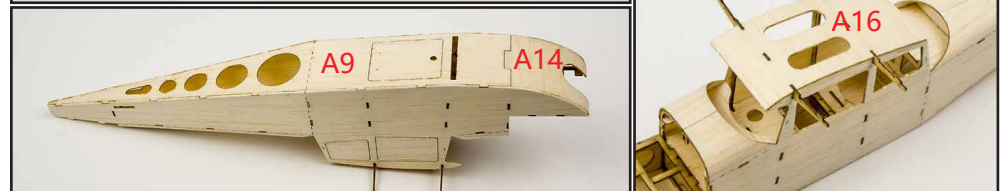
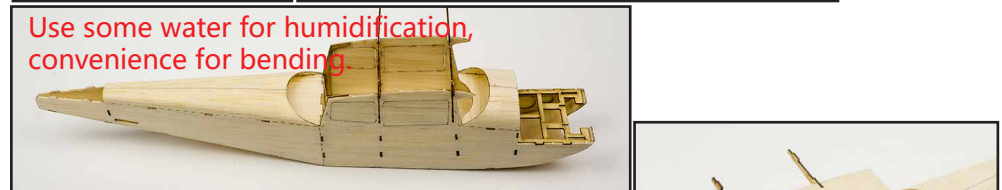
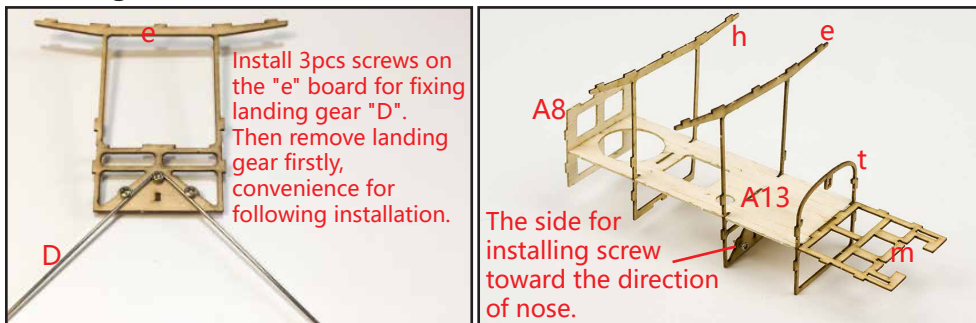

3. Wing Installation



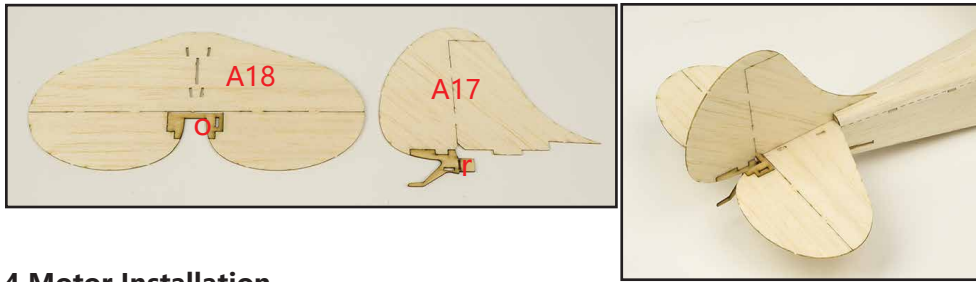

4. Motor Installation

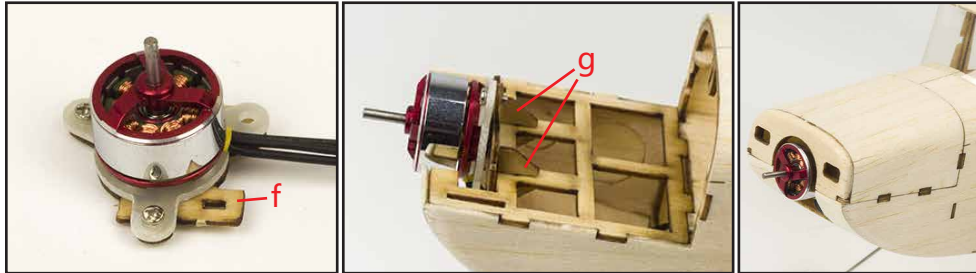

5. Wheels and landing gear installation

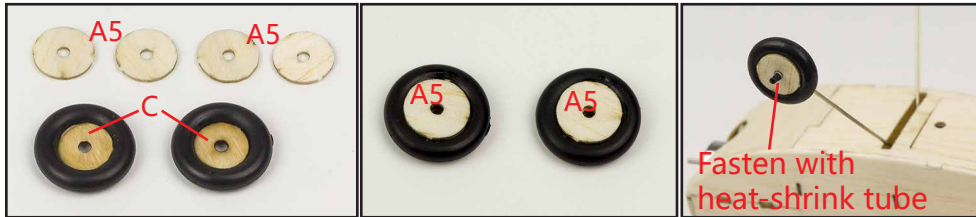

6. Install PVC windshield (Take down from F, compare the shape, then glue it on the fuselage.)



7. Power System Installation

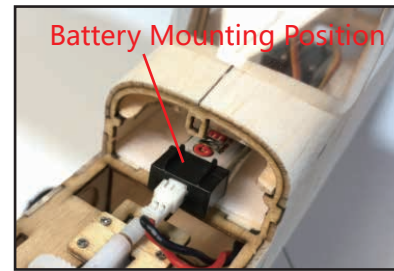
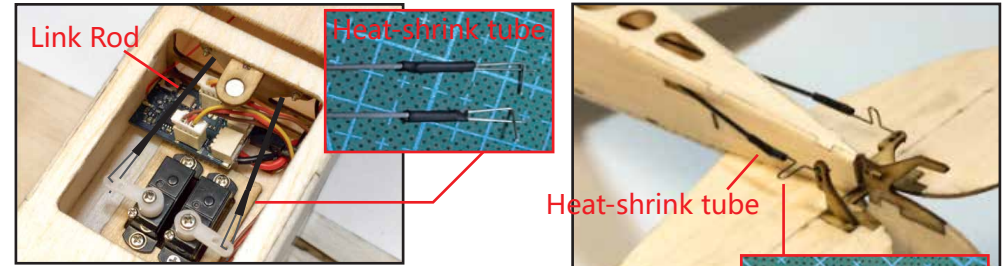
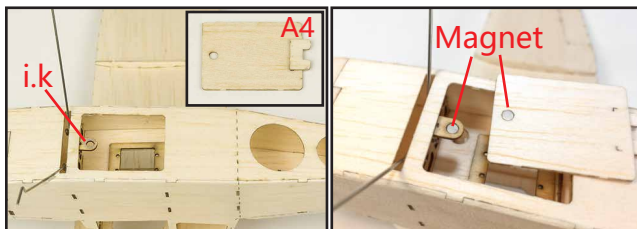

Adjust battery position front or back to adjust CG of this airplane.

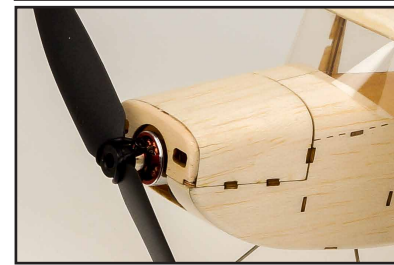

Prop Saver and propeller Installation

Specification

Wingspan:445mm
 Length:320mm
 Flying Weight:~35-50g
 Suggested Motor : 1104 3700KV
 Suggested ESC : 1S 5A
 Suggested Prop : 4530-5030
 Suggested Servo : 1.7g*2
 Suggested BATT : 1S 150-250mAh

8. Suggested CG (centre of gravity) for reference.

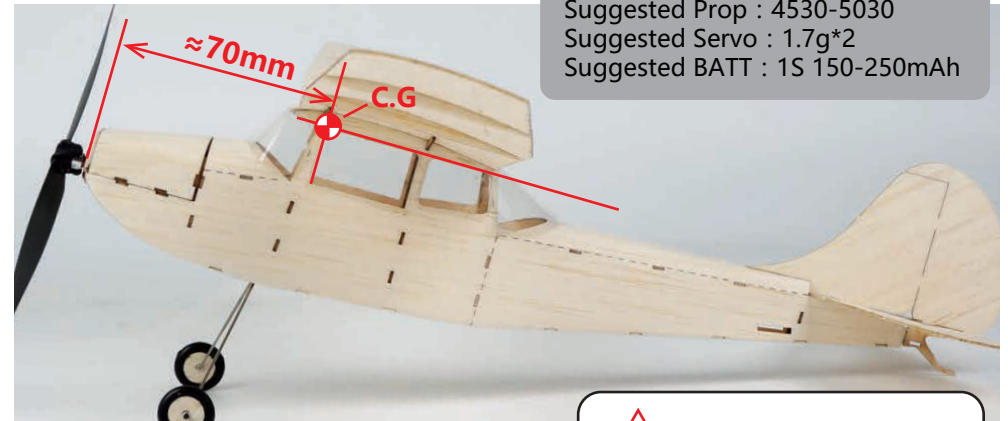

WARNING: CHOKING HAZARD-Small parts. Not for children under 3 years.